

C L A S S I C

Fairway

Golf Car Club Canopy



Assembly and Care Instructions

Instructions: Fairway Golf Car Club Canopy

⚠ Warning!

When installed, the canopy extends out past the back of the golf car. Additional care should be taken when backing up.

Cleaning

Don't clean the plastic window when it is dry—you can scratch it. The best way to clean the window is to hose it with water and to rub with your bare hands or a very soft cloth. Liquid soap may be used. During freezing weather an automotive windshield solvent and a soft cloth will work. Fabric areas of the canopy may be washed with a rag or soft bristle brush and a mild soap.

One Year Warranty

This product is factory warranted for workmanship and materials for one year from the date of purchase. This warranty assumes normal use and conditions and does not include rental use.

Important! Before Fitting!

If at all possible, do step 1 one to two days before first use. This is to allow the adhesive on the hook and loop to cure. If possible, having another person assist during assembly will be helpful.

Tools Needed:

Two adjustable wrenches
Small block of wood or piece of cardboard

Parts:

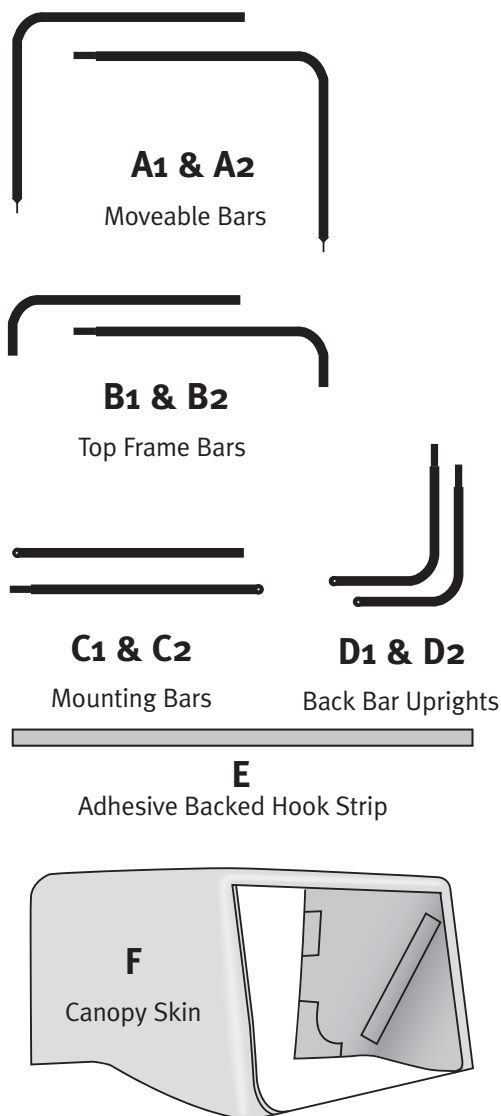

Hardware (not actual size):

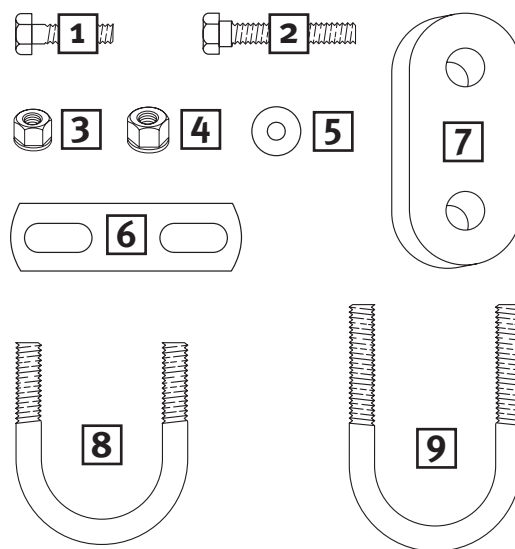

Key	Qty	Description
1	2	Bolt, 1/4"-20 x 3/4" hex
2	2	Bolt, 1/4"-20 x 1-1/4" hex
3	4	Locknut, 1/4"-20
4	8	Locknut, 5/16"
5	4	Nylon washer
6	6	Plate for U-bolts (two extra)
7	2	U-bolt spacer
8	2	U-bolt, 5/16 x 1-1/2" x 2-1/2"
9	2	U-bolt, 5/16 x 1-1/2" x 3-1/4"

Golf car canopy finished assembly:

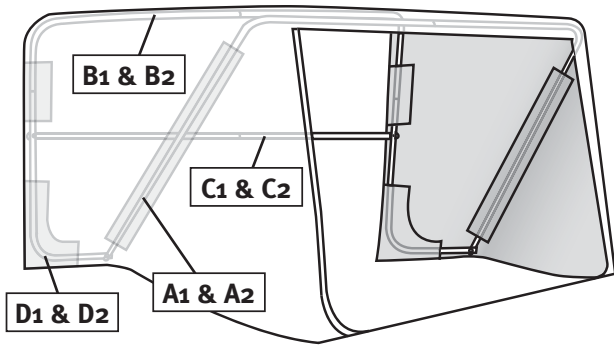

Golf car canopy installation:

1. Apply adhesive hook strip to the rear underside of the car roof.



Locate the adhesive backed hook strip [E]. Hold the strip horizontally and peel an inch or so of the adhesive backing from the top end. Align the strip along the rear underside of the car roof. Slowly peel off the backing as you press the strip against the roof.

Using a small wood block or piece of cardboard press the strip firmly down along its entire length.

Wait one or two days for the glue to cure before proceeding.

2. Insert the moveable bar.

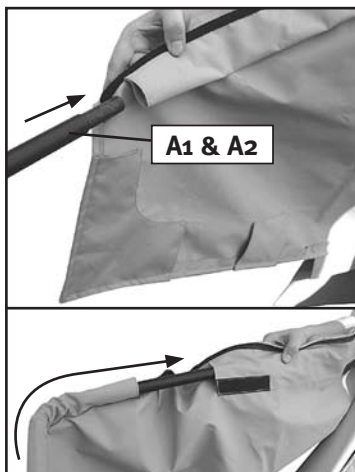

Start by inserting the round ends (not the flattened ends) of both moveable bars [A1 & A2] into the fabric sleeves on the sides of the canopy skin [F].

Continue inserting the bars into the long sleeve on the top of the canopy near the top of the back window. One end

of one of the moveable bars [A1 & A2] is tapered. Once the ends of both bars are in the long sleeve at the top of the canopy, the bar with the tapered end should slide into the other bar end until the wire retaining clip clicks into the slot.

3. Assemble the back bar uprights.

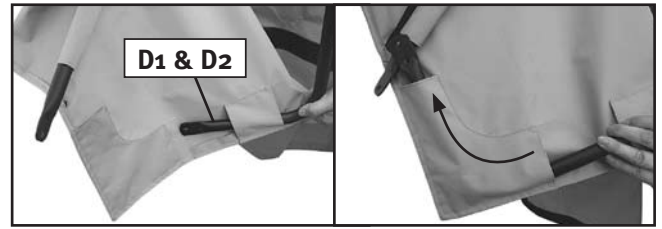

Insert the flattened end of the back bar uprights [D1 & D2] into the top small sleeve along the front of the canopy (opposite of the window).

Continue assembling the top frame bars [B1 & B2] by inserting the tapered long end of one of the bars into the other until the wire retaining clip clicks into the slot. Then insert short tapered ends of the assembled top bar [B1 & B2] into the open ends of the back bar uprights [D1 & D2].

4. Attach the moveable bar and the back bar uprights.

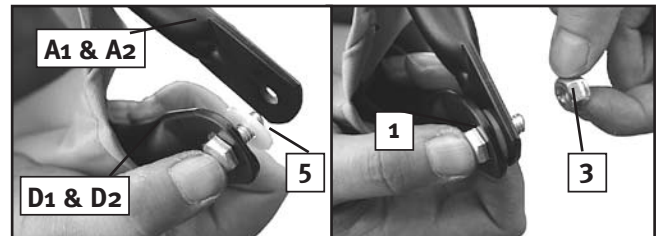

Position the flattened ends of both the moveable bars [A1 & A2] and the back bar uprights [D1 & D2] together making sure that the back bar uprights are to the outside.

Insert in to the pre-drilled hole a 1/4"-20 x 3/4" hex bolt [1]. Next, slide on two nylon washers [5]. Slip the hole in the moveable bar over the bolt and tighten with a 1/4"-20 locknut [3].

5. Assemble and attach the mounting bar.

Slip the mounting bars [C1 & C2] together until the wire retaining clip clicks into the slot.

Now, bolt the mounting bar onto the back bar uprights by inserting 1/4"-20 x 1-1/4" hex bolts [2] into the pre-drilled holes in both bars and tightening with 1/4"-20 locknuts [3].

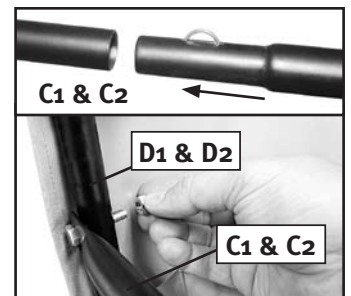

6. Attach the canopy to the golf car.

Note: If possible, having another person assisting with this step will help greatly.

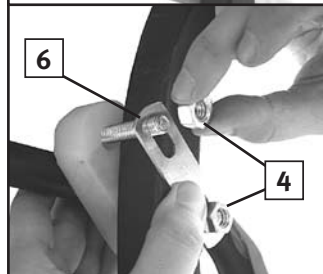
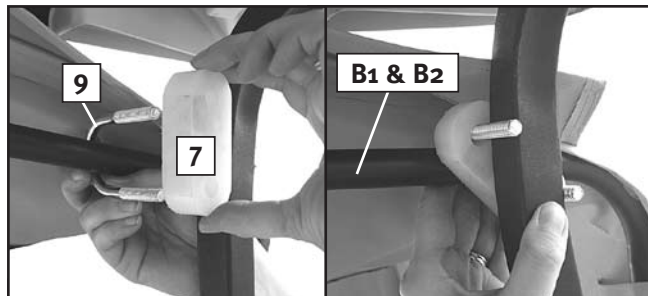

Position the assembled canopy about three inches below the roof on the outside of the roof uprights. Slide a large U-bolt [9] over the horizontal section of the top frame bar [B1 & B2], then slide a

spacer [7] over the U-bolt studs.

Continue by sliding the U-bolt and spacer over the car roof upright. The U-bolt will be at an angle, as shown above. Next, slide a U-bolt plate [6] over the exposed studs and tighten with 5/16" locknuts [4]. Repeat with the other side making sure the top bar of the back bar upright is level with the car roof.

Next, slide a small U-bolt [8] over the mounting bar [C1 & C2] and car roof upright, slide a U-bolt plate [6] over the studs of each U-bolt and tighten using 5/16" locknuts [4].

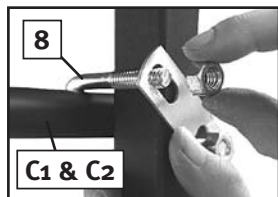

Ideally, the angle of the top of the canopy should be either horizontal with the ground or sloping slightly away from the car. This will ensure that any moisture will flow away from the car occupants.

Since there are many different types of golf cars with various angles of roof uprights, you may have to move the pieces used to attach the canopy to the car around to achieve the best fit.

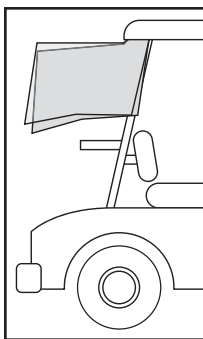

7. Attach the back flap.

Once the canopy is mounted on the rear car roof uprights, find the back fabric flap on the canopy skin with the black hoop velcro strip, pull it up and forward and attach it to the hook velcro tape strip on the underside of the car roof.

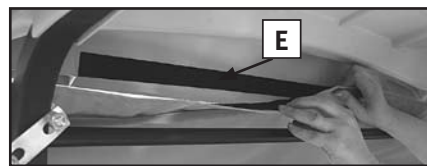

8. Retracting the canopy.



In the event you want to retract the canopy, first roll up the clear window flap and place on the canopy roof. Next, fold back the flaps on the front and push the moveable bar [A1 & A2] against the back bar top frame bars [B1 & B2] while tucking in the sides of the canopy. Find the fabric flap with a strip of loop velcro on the top of the canopy and pull it down and around the folded canopy and attach it to

the other strip of hook velcro on the underside of the canopy roof.

Enjoy your new canopy!



22640 68th Ave. S.
Kent, WA, USA 98032
www.classicaccessories.com
Email: customerservice@classicaccessories.com

Tel: (253) 395-3900
Fax: (253) 395-3991

 **CLASSIC
ACCESSORIES**

WE COVER YOUR GEAR®

©2007 Designed in the U.S.A.